

1 x Anora dual lit LED mirror cabinet 700 x 500mm

Code: 121853

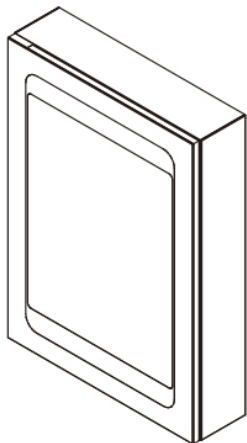

DIMENSIONS:

Height: 700mm
Width: 500mm
Depth: 140mm

CARE AND MAINTENANCE:

- Ensure that the power is disconnected prior to cleaning.
- To maintain the finish of this product, clean with a soft cloth periodically.
- Do not use harsh chemical solvents, as this may discolour or damage the finish.

IMPORTANT SAFETY INFORMATION:

Please read these instructions carefully before attempting to install this product. It is advisable to keep these instructions in a safe place for future reference.

We recommend that you consult a qualified electrician. All electrical installations must be carried out in accordance with current IEE wiring regulations (BS7671).

- This product must not be modified as it may invalidate the warranty and may render the product unsafe.
- This product is only suitable for connecting to a 240V 50Hz supply.
- Before commencing installation or maintenance, isolate the main electrical supply for the appropriate circuit at the fuse board.
- This product should be used indoors only.
- This cabinet should be installed on a smooth flat secure surface.
- The wall fixings supplied are only suitable for brick walls. for any other wall substrate please purchase alternative wall fixings.
- When installing please take care to avoid water pipes, joints and electrical cables.
- Do not exceed or stretch the cable length of each LED wire.
- This cabinet contains 159 LED's, please test that they are working correctly before hanging.

COMPONENTS

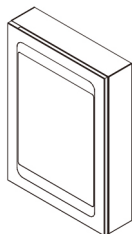

1 x Mirror.

Screws and spacers attached

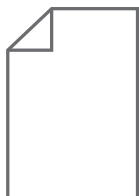

1 x instructions

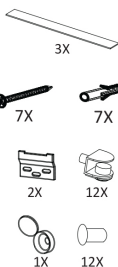

TOOLS REQUIRED

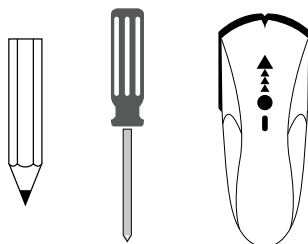

Pencil

Screw driver

Stud detector

INSTALLATION

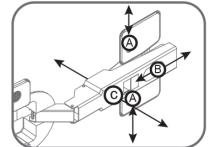
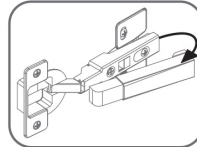
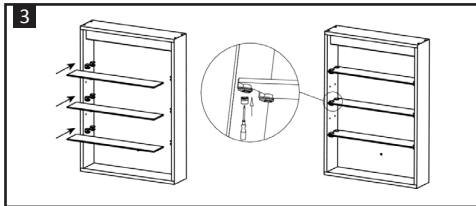
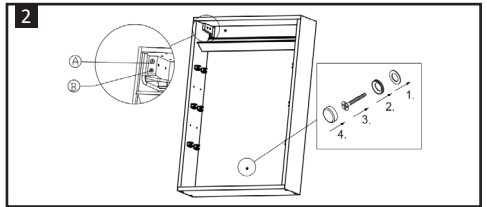
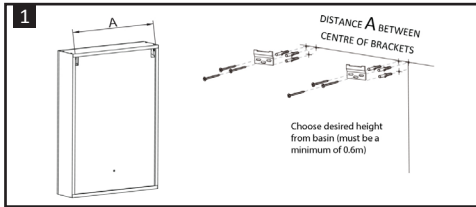

Lift the cabinet from the packaging and position on a soft flat surface to avoid scratching the mirror.

The mirror must be installed with a minimum clearance of 150mm between the infrared sensor and any adjacent countertop or obstruction to ensure correct function of the sensor. Mark a desired height of the cabinet and draw a horizontal line on the wall which corresponds with the height of the cabinet hangers. Drill the required holes and insert the wall plugs using a stud detector to ensure you avoid any wiring or water pipes.

The wall plugs supplied are only suitable for solid stone/brick walls. Screw the brackets to the wall using the screws provided. Please ensure they are fully tight.

Make sure to turn off the electrical supply at the mains, then connection must be made in accordance with the latest IEE regulations. This cabinet is manufactured to Class I and requires an earth connection.

Hang the cabinet on the wall bracket. The claws on the cabinet hangers must be securely located on the wall brackets. Use a spirit level to adjust the angle of the cabinet by turning screw A with a cross head screwdriver.

When the angle is properly adjusted, tighten screw B on both hangers. Then secure the base of the cabinet to the wall with the screw and over-cap.

Close and secure the internal top electrical cover with the small screws

removed earlier and switch on the electrical supply at the mains to test the function of the lamp and the shaver socket.

Insert the shelf supports in the desired positions starting with the top shelf. Insert the glass shelves and please make sure to tighten the plastic screw at the bottom of the shelf support to prevent the shelves becoming loose. Rubber plugs provided can be used to cover unused shelf holes.

If the doors are out of alignment, please first remove the soft-close buffer (from bottom hinges), then adjust the screws A, B and C on hinges for 3 directional adjustment, see diagram.

ZONE

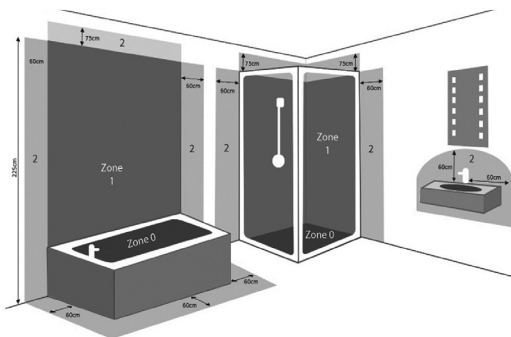

0 Inside the bath or shower. Must be SELV (12V max) due to water submersion.

1 225cm above the bath or shower.

2 The area stretching to 60cm outside the bath or shower and 60cm from water outlet of sink.

Outside Zones. Anywhere outside zones 0, 1 & 2. Where water jets are not used for cleaning purposes, the general rules of BS7671 apply.

This mirror is IP44 rated therefore suitable for installation in zone 2 and the outside zones.

Waste Electrical & Electronic Equipment (WEEE)

The symbol on the product, or on the document accompanying the product, the crossed out wheelee bin symbol, indicates that this product may not be treated as household waste. Instead it shall be handed over to the applicable collection point for the recycling of electrical and electronic waste.



RoHS Compliant



Technical drawings are for illustration purposes only. Make sure you check all hole cut outs before work commences.