



Product features:

- Metal & ABS construction
- Quarter turn handle action for precise flow control
- Custom designed for lower range pressures
- Swivel spout for maximum flexibility
- Single spray pattern showerhead

Packaged properties:

Box length (mm): 380

Box depth(mm): 105

Box width(mm): 255

Boxed weight (Kg): 3.9

Includes pop up waste?: No

Additional comments:

Includes fixed shower bracket & round showerhead

Product dimensions:

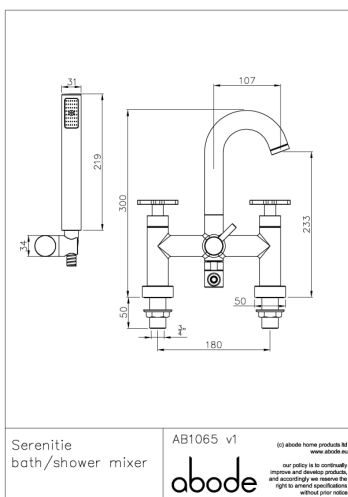

- **Product mounted where:** Surface
- **Recommended hole size:** 32 mm
- **Overall Height / projection:** 300 mm
- **Exit reach:** 107 mm
- **Exit height:** 223 mm
- **Base size:** 50 mm
- **Inlet centre distance(s):** 180 mm

- **Min. fitting depth required:** 35 mm
- **Max. surface depth:**

Product flow characteristics:

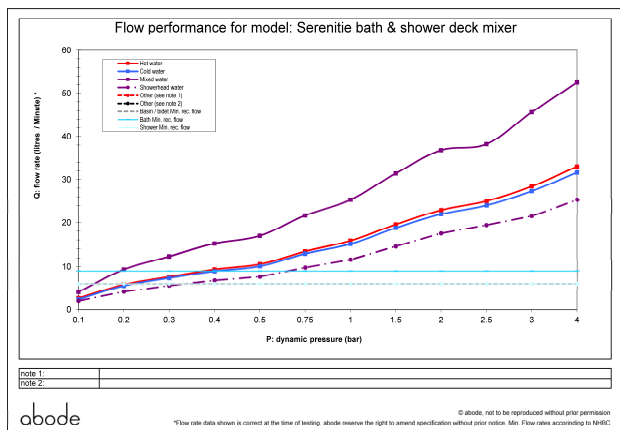

- **Min / Max water pressure (bar):** 0.20* / 5.00
*Detailed minimum pressure requirements for this product: Bath 0.2, Shower 0.3 (bar)
- **Part G max. mixed flow rate at 3 bar (l/m):** bath=45.6, shower=21.5
- **Inlet connection type / length:** Fixed / 65 mm
- **Inlet (plumbing connection) / outlet size:** 3/4" M /
- **Product flow characteristics:** Single flow
- **Non return valve(s) supplied or position:**
- **Aerator type:** White flow straightener
- **Control valve type:** 1/2" QT CD (8-20)
- **Includes output diverter?:** Yes
- **Inlet meshed particle filters included:**
- **Shower hose type / length:** Smoothflex / 1.50 m

Warranty Summary (full details available on request):

- Materials and workmanship defects warranted for 5 years
- Valves and working parts warranted for 5 years
- Surface warranty defects warranted for 1 year
- O-rings, hoses & gaskets warranted for 1 year

Care instructions:

- Clean the mixers and showers regularly as required, using soap, do not use any other cleaners.
- Regular cleaning will prevent the build up of lime scale and dirt
- After cleaning rinse thoroughly with clean water to remove any cleaner residue
- Residues of liquid soaps, shampoos and shower foams can also cause damage, so rinse with clean water after using, avoid contact with any abrasives