

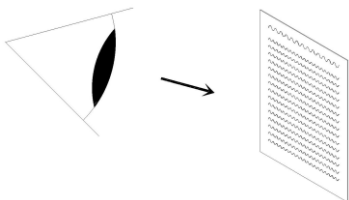

FITTING INSTRUCTIONS

888919	IFLO Breton 1500X700
888918	IFLO Breton 1600X700
888912/888914	IFLO Breton / Evo 1700X700
359408	IFLO Strasbourg Offset Corner Bath LH
359409	IFLO Strasbourg Offset Corner Bath RH
888944	IFLO Rennes P Shaped Showerbath LH
888945	IFLO Rennes P Shaped Showerbath RH
359412	IFLO Lausanne 1700X800 D Shaped Bath
888910/888911	IFLO Rodez / Evo 1700X750
888915	IFLO Breton Low Cap 1700X700
888916/888917	IFLO Breton / Evo 1700X750
888942	IFLO Metz L Shaped Showerbath LH
888943	IFLO Metz L Shaped Showerbath RH
888946	IFLO Limoges 1800X800
888947	IFLO Moulin 1700X750
888948	IFLO Moulin 1700X700
888949/888950	IFLO Rodez / Evo 1700X700

1)



- Read Instructions carefully before installing this product.

2)



- Always use 2 people when turning the bath over.

3)

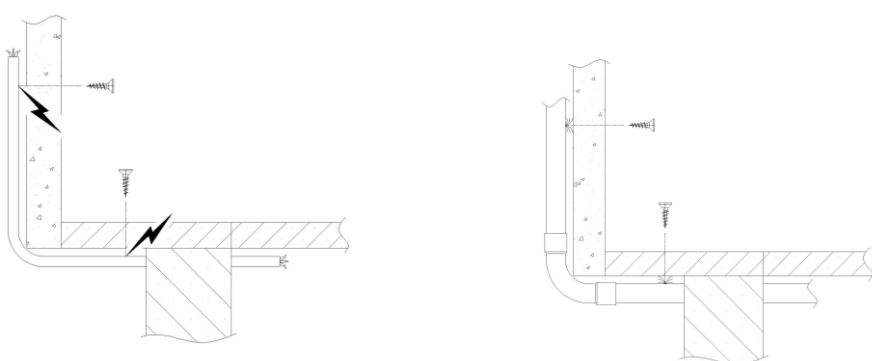

- Always be aware of hidden pipes & wires when drilling into walls & floors.

4)

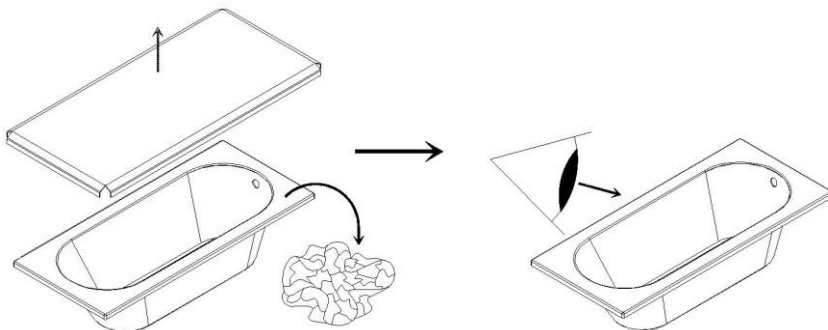

- Remove cardboard sleeve. Remove & discard protective film. Carefully inspect the bath. **Any faults should be reported to your branch prior to installation.**

**Ancillary Pack Parts for
Breton 1500 (888919), 1600 (888918), 1700 (888912/888914), Low Cap (888915) & Rennes P Shape L/H
(888944) + R/H (888945) & Limoges 1800 (888946) & Moulin 750 + 700 (888947/48) & Rodez 700 + 750
(888949/950/910/911)**

Article Reference	Description	Quantity
A	Metal channels 540 mm	2
B	Central support	1
C	Bolts M10 x 110mm	5
D	Hexagonal nuts M10	15
E	Wood screw 15mm	10
F	Adjustable feet	5
G	Wall bracket	2
H	Tubular Jack support leg 480mm	2
E	Wood screw 15mm	4
J	Black plastic holder	2
K	Self tapping screw 16 mm	2

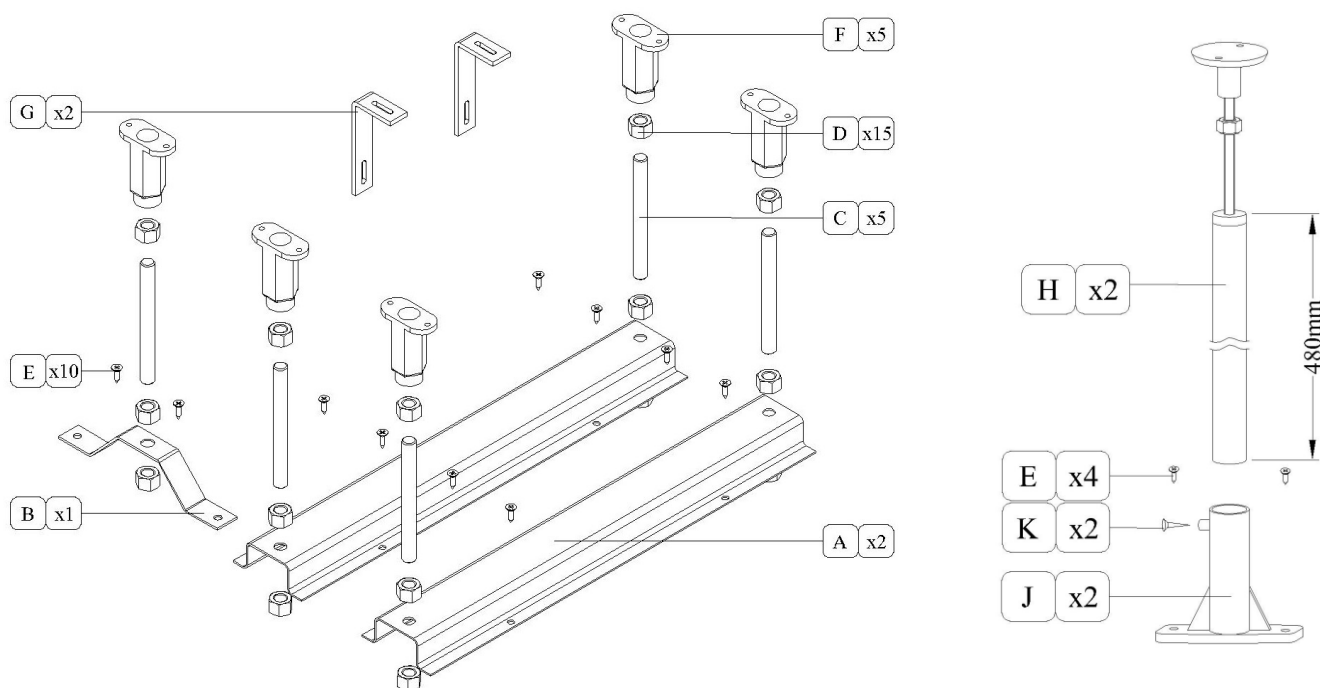

**Ancillary Pack Parts for
Metz L Shaped L/H (888942) & R/H (888943)**

All components supplied as above, with the following exception

Article Reference	Description	Quantity
A	Metal channel 540 mm	1
A	Metal channel 630 mm	1

Ancillary Pack Parts for IFLO Strasbourg Offset Corner Bath LH (359408) + RH (359409)
--

Article Reference	Description	Quantity
A	Metal channels 540 mm	2
B	Central support	1
C	Bolts M10 x 110mm	5
D	Hexagonal nuts M10	15
E	Wood screw 15mm	10
F	Adjustable feet	5
G	Wall bracket	2
H	Tubular Jack support leg 275mm	1
E	Wood screw 15mm	2
J	Black plastic holder	1
K	Self tapping screw 16 mm	1

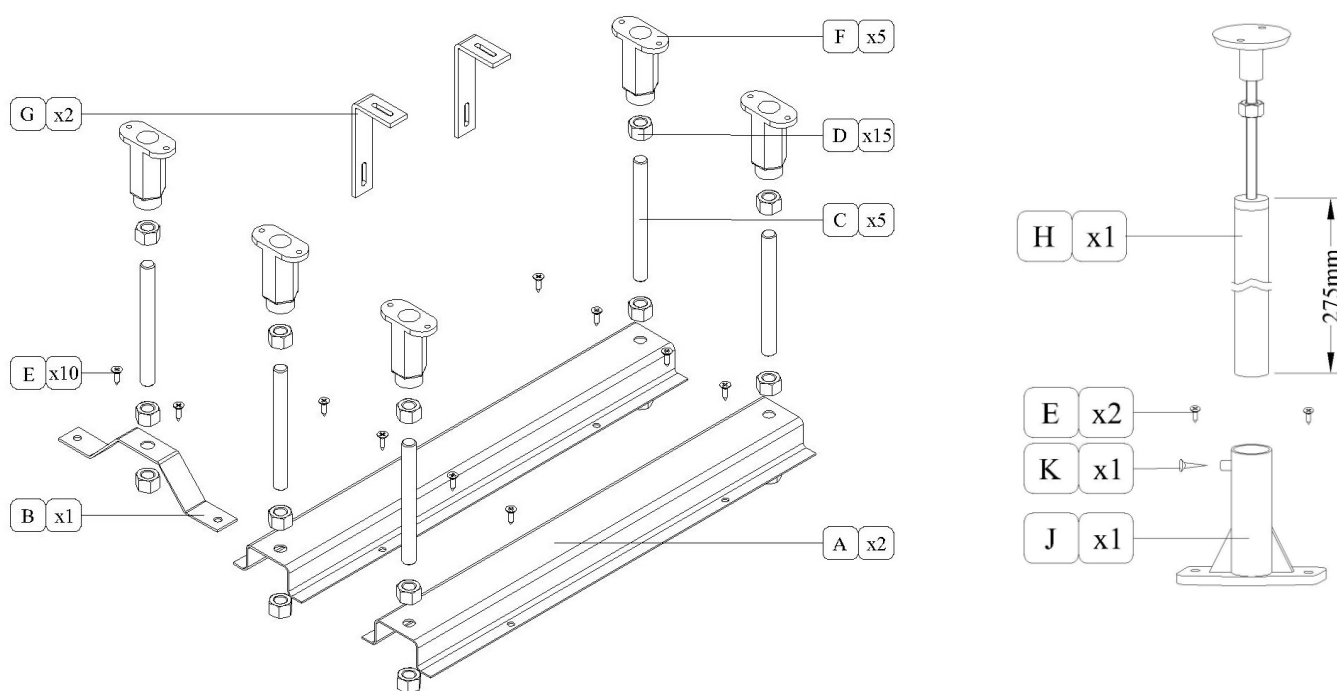

Ancillary Pack Parts for IFLO Lausanne 1700X800 D Shaped Bath (359412)

Article Reference	Description	Quantity
A	Metal channels 540 mm	2
B	Central support	1
C	Bolts M10 x 110mm	5
D	Hexagonal nuts M10	15
E	Wood screw 15mm	10
F	Adjustable feet	5
G	Wall bracket	2
H	Tubular Jack support leg 480mm	4
E	Wood screw 15mm	8
J	Black plastic holder	4
K	Self tapping screw 16 mm	4

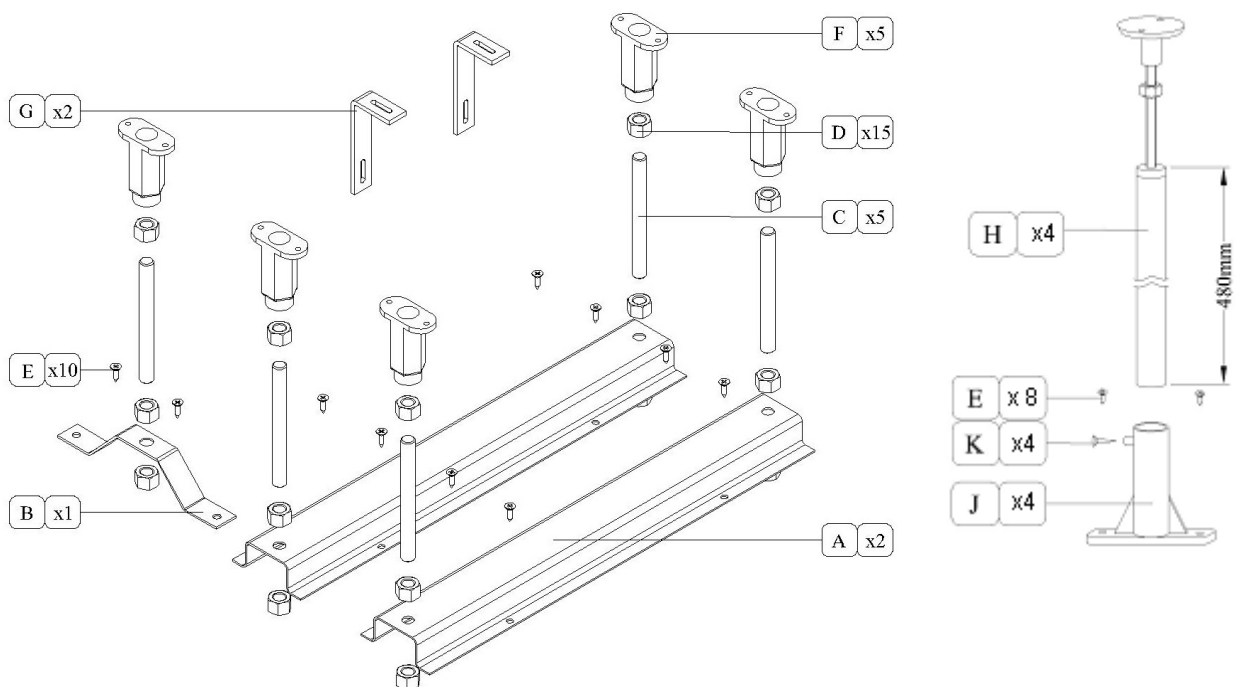

5)

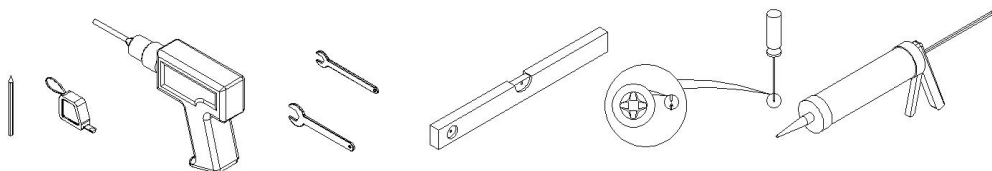

- Tools required (not supplied).

6)

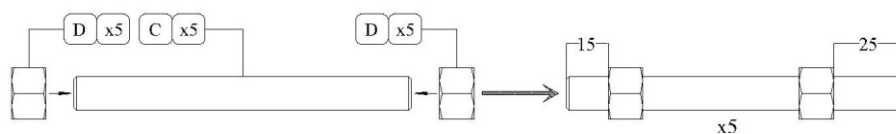

- Assemble nuts & bolts as shown.

7)

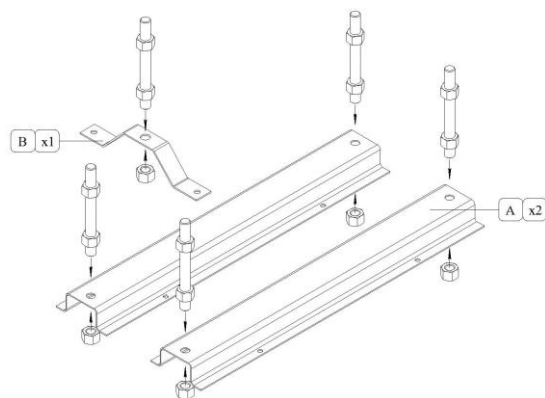

- Assemble bolts to channels.

8)

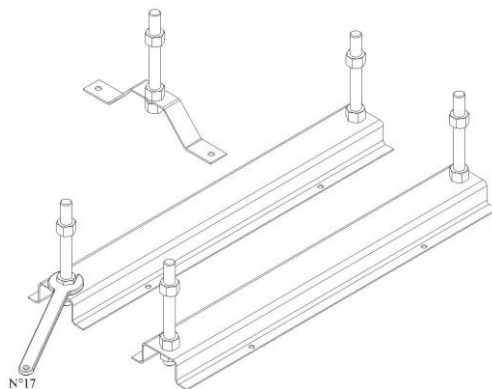

- Secure bolts to channels.

9)

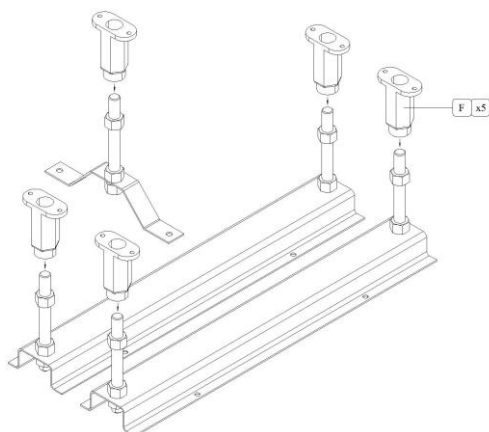

- Assemble feet to bolts.

10)

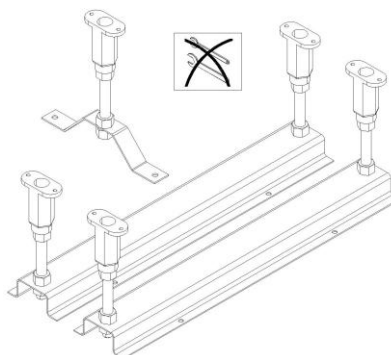

- Screw the feet onto the bolts. Do not secure at this stage.

11)

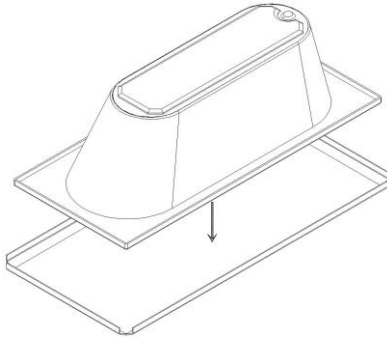

- Place the bath face down. Use the clean cardboard sleeve to protect the face.

12)

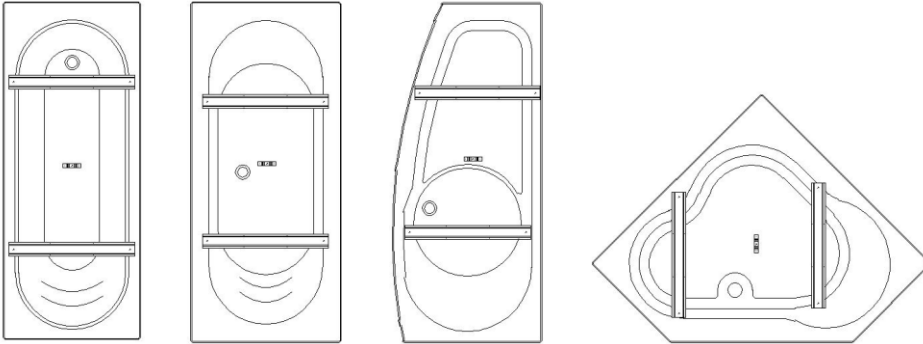

- Choose the image from above that is the best match for the bath that has been purchased. Position the channel legs as shown.
- If installing the L Shaped Shower bath, the longer (630mm) channel to be used at the wider, showering area.

13)

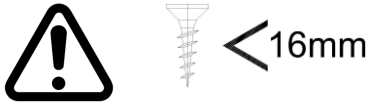

- When screwing into the bath DO NOT use any screws longer than 16mm!

14)

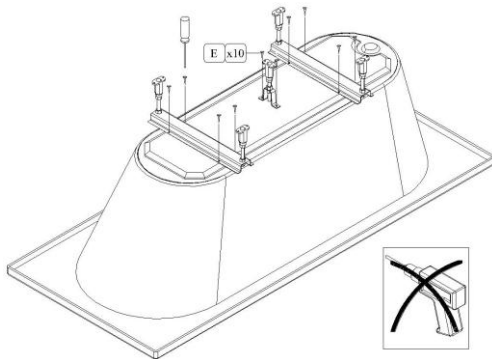

- Screw channel legs into baseboard. **No need to pre-drill.**

15)

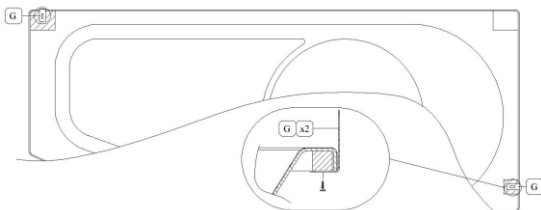

- Fit wall brackets if required into wooden frame or plastic blocks of bath (screws not supplied).

16)

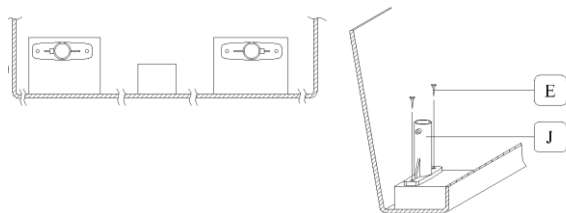

- Screw jack leg sockets into wooden frame or plastic blocks evenly spaced along the length on the product.

17)

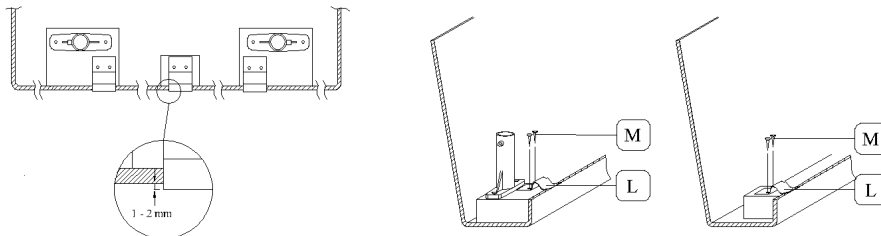

- Screw panel clips (if required - supplied with panel) into wooden frame or plastic blocks.

18)

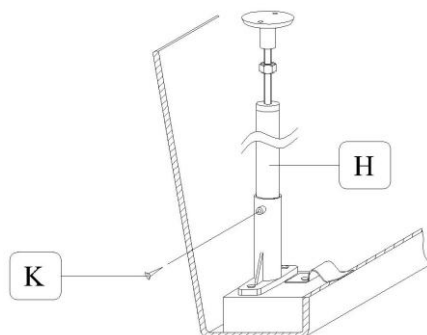

- Insert jack leg firmly into socket. Drill \varnothing 3mm through boss & secure with screw.

19)

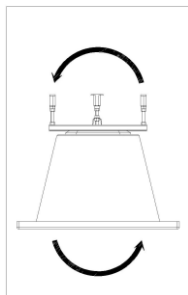

- Turn bath over.

20)

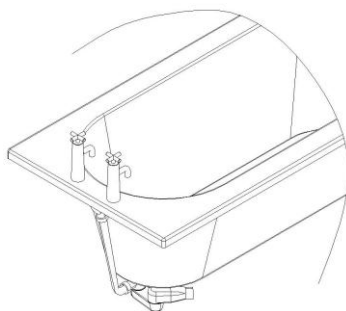

- Fit taps, waste & overflow to the bath following the manufacturer's instructions.

21)

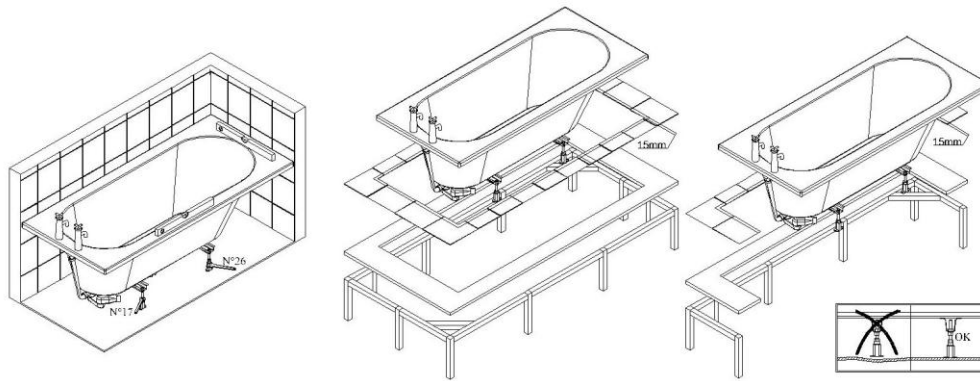

- Place bath in position (in a corner or in a frame or half frame). Do not secure on an uneven floor.

22)

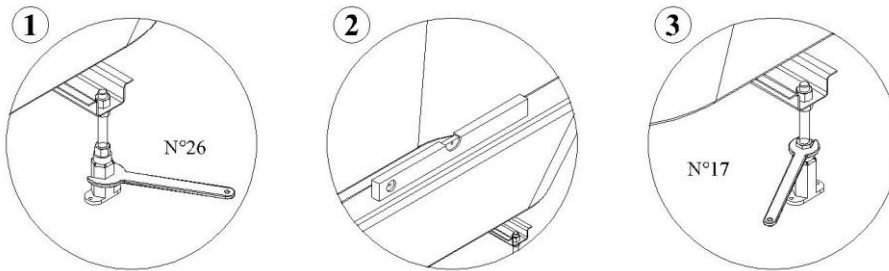

- Adjust the feet until the bath is level & at the correct height. Place the level on the rim of the bath, not in the bath. Secure the nuts to the feet.

23)

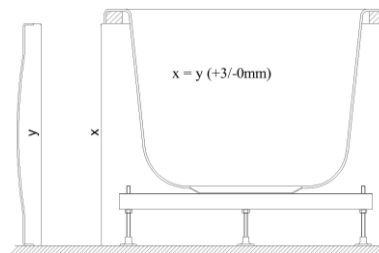

- If a panel is being fitted then ensure the bath is at the correct height.

24)

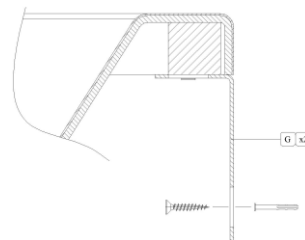

- Fit to wall if required (screws not included).

25)

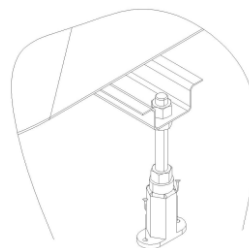

- Secure the feet to the floor (screws not included).

26)

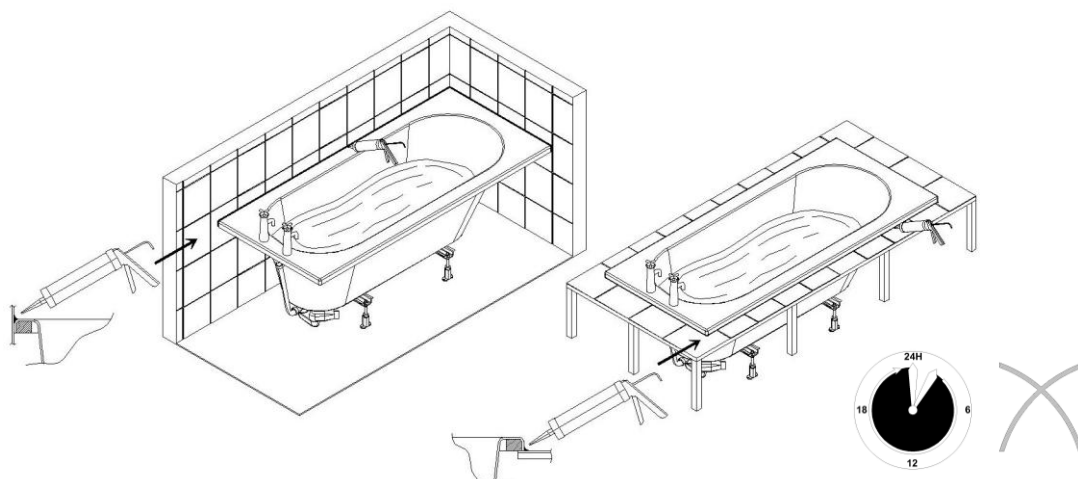

- Fill the bath with water and verify that all the pipes are watertight. Seal around the bath with sanitary silicone. Drain and use the bath only when the silicone has hardened. (Approximately 24h).

27)

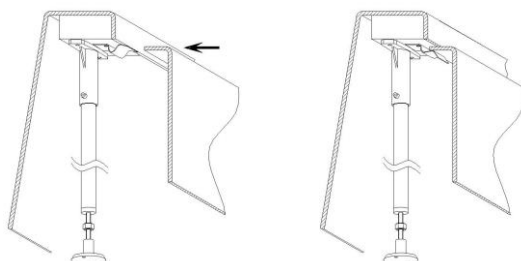

- Fit the panel into the clips if required.

Bath Care Instructions

The acrylic bath is guaranteed by the manufacturer against defective materials or workmanship. This guarantee does *not* cover impact related damage.

FILLING

Always run some cold water into the bath before turning on the hot tap

CLEANING

The bath should be cleaned immediately after use whilst the water is draining and is still warm. Should the bath be cold before draining any residue in the water can harden on the sides and base of bath and will be harder to remove. Hard water locations can leave insoluble lime salts at and below the water line and also below leaking taps. If allowed to build up they are more difficult to remove. Please use hot soapy water for cleaning and wipe the bath dry.

CLEANERS

Gritty and abrasive cleaners must NOT be used. Should grime build up over months this can be removed by using a soft cloth and a car colour restoring polish or a metal polish. Any slight surface scratches can be removed by the same method.

CHEMICALS

Acrylic has good resistance properties to acids and alkalis, but organic solvents, such as paint strippers, peroxide etc. can cause damage to the bath surface and should not be allowed to contact the surface of the bath. If by accident this does happen, dilute with hot soapy water and wash away drying the surface

Burning cigarettes must never be allowed to contact the surface, as damage will ensue.

Guarantee

We guarantee our products against defects in workmanship and materials. The period of the guarantee is twenty-five years from the date of purchase of the product. This guarantee is subject to the following conditions and exclusions:

1. You must retain your purchase receipt and produce it to us in the event of a claim. The guarantee commences from the date of purchase.
2. The product must have been installed, used and cared for in accordance with our Instructions for installation and care. In addition, the products must have been installed in accordance with good plumbing practice.
3. We must be given the opportunity to inspect the product where it has been installed, if we request to do so. The product should not be removed before inspection without our consent.
4. Where we are satisfied that a defect has arisen in manufacture because of faulty workmanship or materials we will, at our option, repair or replace the product free of charge to you. If we choose to replace the product and we no longer manufacture the identical model we will replace it with the nearest equivalent in our then current range.
5. This guarantee does not apply to general wear and tear or where, in our opinion, the product has been modified, misused, neglected or wilfully or accidentally damaged.
6. This guarantee does not extend to the costs of removing the defective product and installing the replacement product or to any other costs or losses.
7. If we supply a replacement product this guarantee shall apply to the replacement product for the balance of the original guarantee period for that product.
8. This guarantee applies only to products installed in domestic premises and is not transferable to a new owner of the product.

Nothing in this guarantee affects your statutory rights.