

Product Description: FEMALE STRAIGHT ADAPTOR

Product Specification

Material: Copper

Product Code & Size:

909039 FEMALE STRAIGHT ADAPTOR 15mm x 1/2"

909054 FEMALE STRAIGHT ADAPTOR 22mm x 3/4"



Technical Information:

Compliant to BS EN 1254-1

WRAS approved (Suitable for Drinking Water Installation)

Kitemark approved (Suitable for Gas Use)

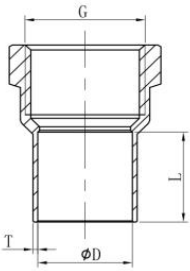

SIZE	D	L (min)	T (min)	G
15*1/2	15.06 ₀ ^{+0.09}	10.6	0.7	G1/2
22*3/4	22.07 ₀ ^{+0.11}	15.4	0.9	G3/4

Additional Information

For Gas:

MOP 3

max 70°C

Guarantee Period:

25 Years against Manufacturing Defects