

# TECHNICAL DATA SHEET



CPS Product SKU Code: 109535

Product Description: Iflo Shaker Modular 600 Freestanding Vanity Unit Matt White

## Product Specification

Furniture Dimensions:

Height: 816.5mm (880mm including basin)

Width: 582mm (630mm including basin)

Depth: 448mm (465mm including doors)

Materials:

- Cabinet is made from fully encapsulated Melamine Faced Chipboard (MFC)
- Doors are made from 18mm MDF core, PVC wrapped.

Systems: Modular Furniture

## Additional Information

### F&B (Features & Benefits):

- 18mm MFC with sealed edge banding to prevent moisture ingress (note: please make sure the floor is dry - water will penetrate the furniture if constantly sitting in water.)
- All timber is FSC or PEFC certified
- Removable back panel to access plumbing pipework and waste during and after installation.
- Adjustable hinges for door alignment
- Adjustable internal shelf
- Product guarantee is 2 years

### Technical Drawings -

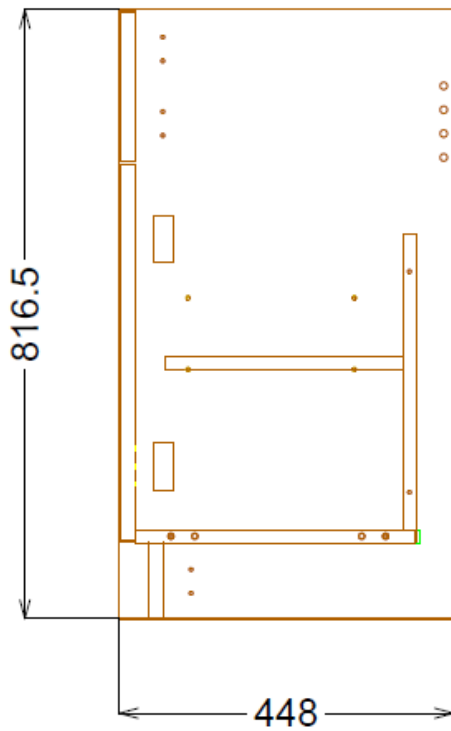

The information contained within this specification sheet is believed to be correct and complete at the time of creation. All photographs / drawings are as a guide only and do not necessarily represent the products available. City Plumbing Supplies Holding Limited reserves the right to change product details and price without prior notice.