

# TECHNICAL DATA SHEET



Product Code: 312073

Product Description: iflo Holton Thermostatic Shower Valve

## Product Specification

Material:  
High grade chrome plated brass

Fittings:  
Recessed fitting

Systems:  
Suitable for all plumbing systems



## Additional Information

Always inspect before installation

Do not clean with abrasive cleaning products

Automatic safety shut down if cold or hot water supplies fail

Single exit concealed shower valve

Separate controls for flow & temperature

Recommended minimum bar pressure 0.2

WRAS approved

Part of the iflo Mix & Match Shower Range

Product Code	Operating Pressures (bar)	Pressure (bar)	Flow rate (l/m)
312073	0.2-5.0	0.1	4.66
		0.2	7.90
		0.3	10.30
		0.4	12.38
		0.5	14.06
		1.0	20.00
		1.5	24.80
		2.0	29.08
		3.0	36.45
		4.0	40.40
5.0	49.56		

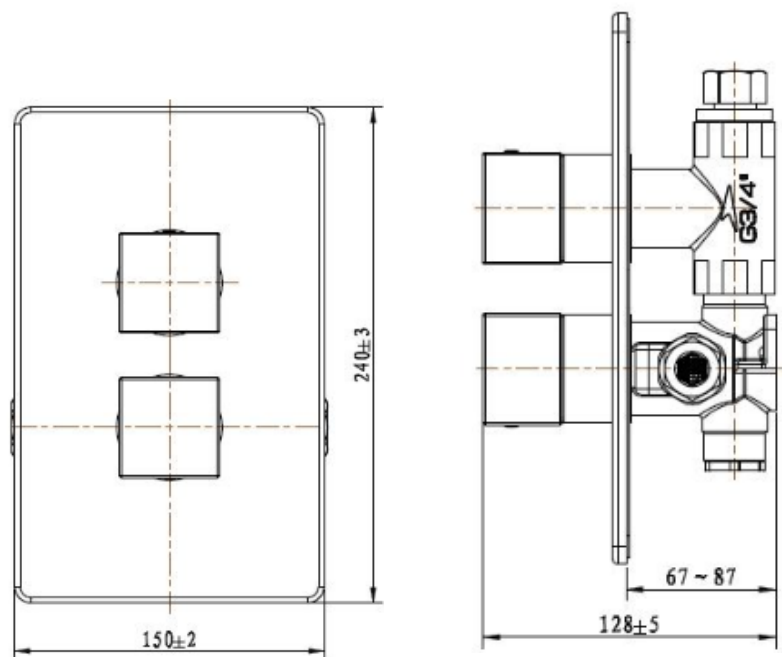

'The information contained within this specification sheet is believed to be correct and complete at the time of creation. All photographs / drawings are as a guide only and do not necessarily represent the products available. Travis Perkins PLC reserves the right to change product details and price without prior notice. E&OE.' [10/2017]