

**Product Code: 517538**

**Product Description: ANGLED TOWEL RAIL RAD VALVE PAIR**

## Product Specification

**Material:** Brass chrome plated

**Size:** 15mm

### Technical Information:

Compression end compliant to BS EN 1254-2

Tail thread end compliant to ISO 7-1

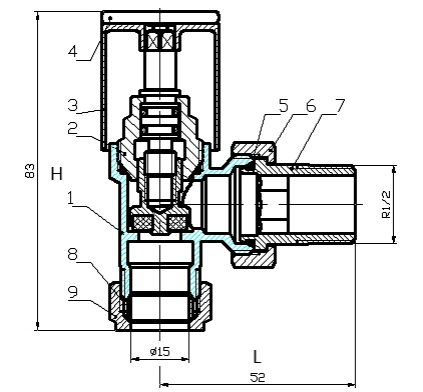

**Manufacture date: MM/YY  
Marked CPS**

Size	DN	L	H	Kgs
15mm	15	52	83	0.5

### Technical Data

Max pressure	10Bar
Max flow temperature	120°C
Field of applications	cold and hot Water

NO.	Part Name	Material	Qty
1	Valve body	Brass	2
2	Big Nut	Brass	2
3	Hexagonal nuts	Brass	2
4	Olive	Copper	2
5	Small Nut	Brass	2

### Guarantee Period:

5 Years against Manufacturing Defects