

STAGE 3

Maintenance and cleaning of filling valve

Cleaning

The Torbeck valve is fitted with a filter which may need cleaning occasionally to ensure that optimum waterflow is maintained. The filter is essential for correct functioning.

The procedure for cleaning the valve is as follows:

- 1 Turn off water.
- 2 Unscrew height adjusting nut and extract grooved telescopic column from pedestal. Note: Float and down fill tube are attached and are integral part of the telescopic column.
- 3 Using suitable pliers, withdraw the flow restrictor and filter located inside the end of the telescopic column and remove for cleaning.
- 4 When cleaning is complete, replace the filter and restrictor and insert telescopic column into pedestal. When satisfied, make sure the collet has 'clicked' into position in the chosen groove, and lock column into position by tightening nut, hand tighten only.
- 5 Turn on water.

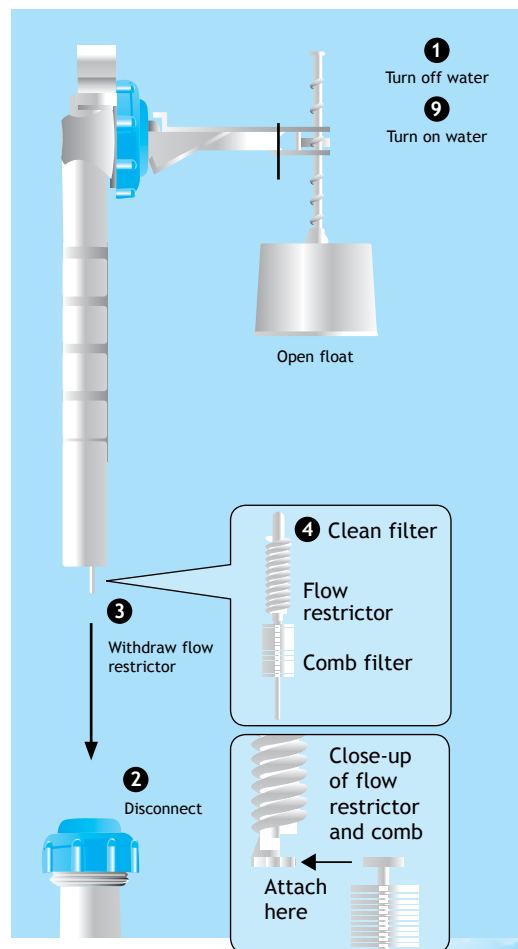

Restrictors and water pressures

1/2" Plastic	No Restrictor
Below 1 bar (14 psi)	L.P Restrictor
From 1-4 bar (14-60 psi)	H.P. Restrictor
Over 4 bar (60 psi)	

Please ensure the correct water flow is maintained using restrictors in relation to the table above. Note, it is essential that the overflow rate must be greater than the infill rate when the valve is fully open.

Warning: Solder flux and some sealing compounds can damage this plastic plumbing product.

Opella Limited

Twyford Road, Rotherwas Industrial Estate, HEREFORD HR2 6JR, England.

t: +44 (0) 1432 357331 f: +44 (0) 1432 264014 w: www.opella.co.uk e: sales@opella.co.uk

features • fitting instructions

Torbeck®

Adjustable height bottom entry filling valve

- Low noise for quiet and efficient fill
- Height adjustable from 8½" to 11½"
- Reduces water hammer
- Neat and compact

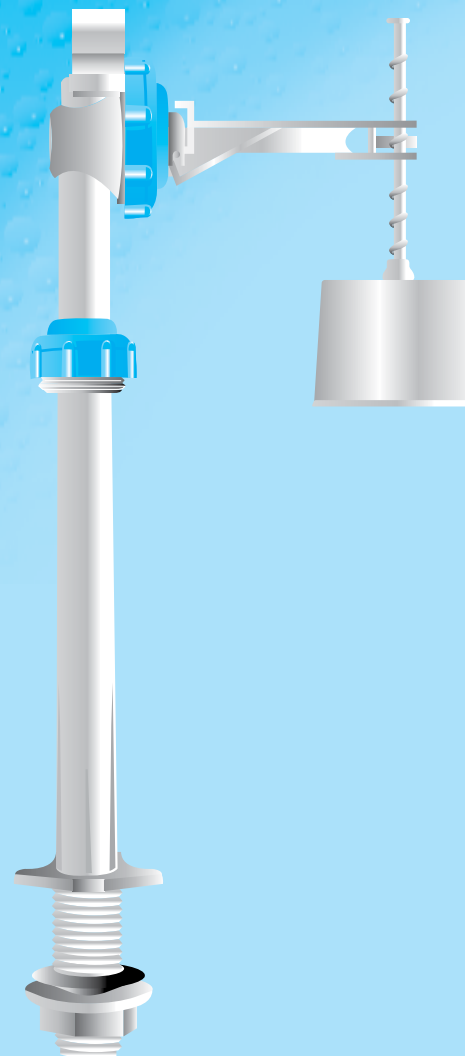

WRAS
APPROVED
PRODUCT

MADE IN
THE U.K.

Opella
plumbing innovations

LF00122

STAGE 1

Pre-installation

- 1 Turn off water supply to cistern and remove cistern lid.
- 2 While still full, mark the normal water level on the inside of the cistern.
- 3 Flush the cistern and remove all remaining water with a sponge or cloth. Ensure all dirt and loose particles are removed as they could impair the filling of the Torbeck valve.
- 4 Disconnect and remove existing filling valve.

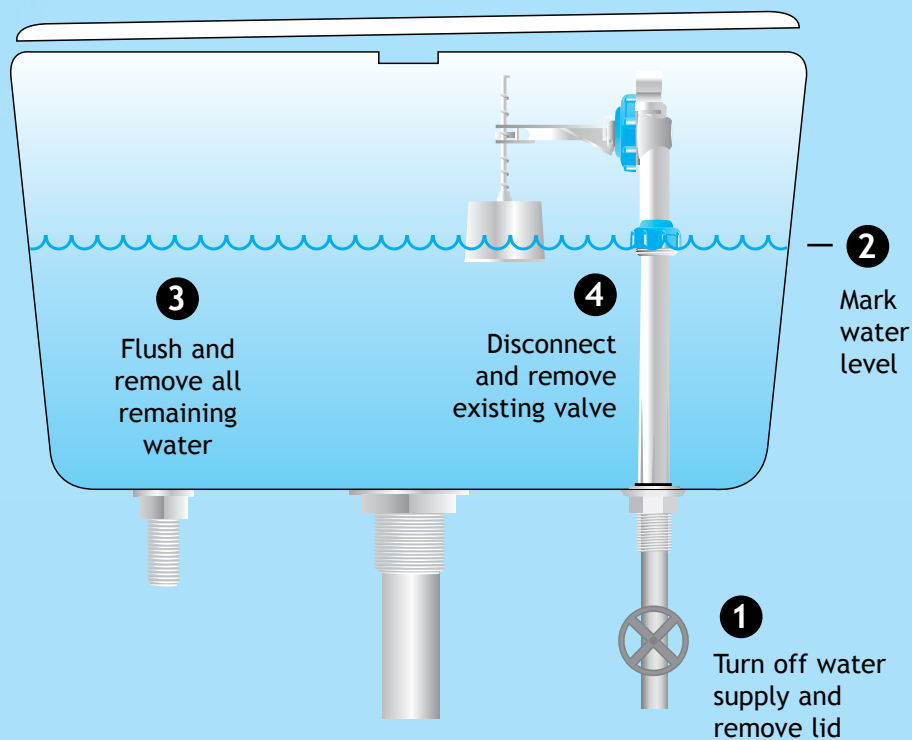

Valve can be fitted on either side of cistern.

STAGE 2

Fitting your Opella Torbeck® filling valve

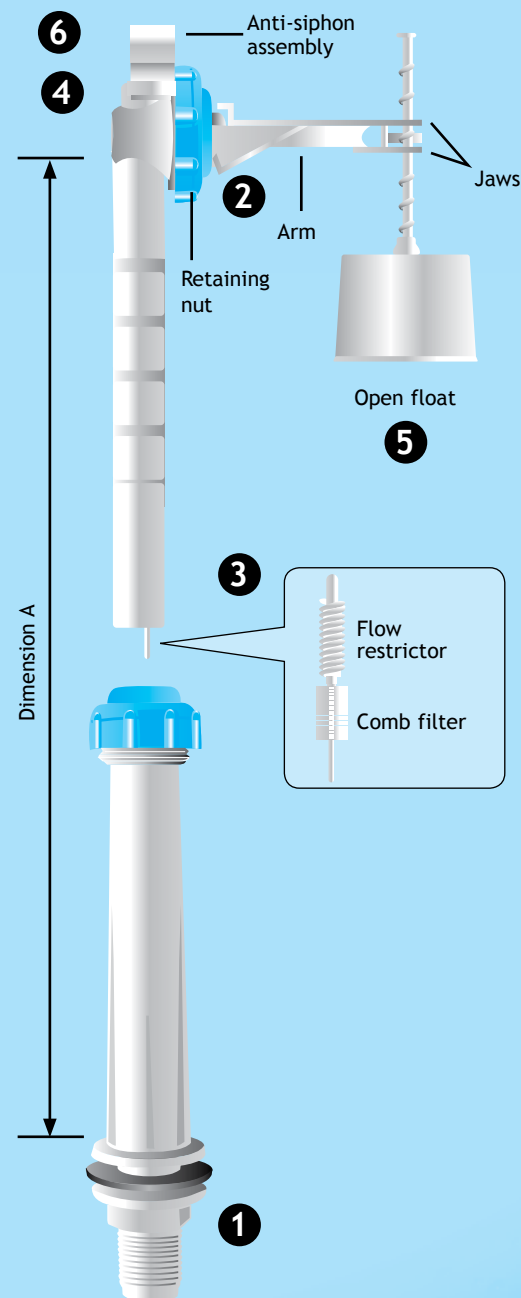

- 1 Fit the Torbeck filling valve ensuring the rubber washer is on the inside of the tank with the conical side face down. Hand tighten the back nut and with a spanner, tighten a further three-quarter turn. **DO NOT OVERTIGHTEN.**

- 2 Insert float spiral stem horizontally between the two lower jaws and twist to engage upper jaw.
- 3 The overall height of the valve can now be altered by simply adjusting the telescopic column. Push together to shorten, or pull apart to lengthen the valve.

IMPORTANT NOTE: The filter, together with the high or low flow restrictor is accommodated inside the end of the grooved telescopic column and is easily removed/exchanged by fully extracting the column and withdrawing with pliers. To set the valve to the correct length (Dimension A), either use the old valve as a guide, or offer the new valve and adjust into position. When satisfied, make sure the collet has 'clicked' into position in the chosen groove, and lock column into position by tightening nut, hand tighten only.

- 4 Check anti-siphon assembly is held securely by retaining nut.
- 5 Turn on the water supply. Allow the cistern or tank to fill. Adjust water level by twisting float up or down.

IMPORTANT FOR NEWBUILD/ INSTALLATIONS:

Before turning water on, ensure that one cold water tap is open so that dirt and loose particles in the pipe work are flushed through the tap.

- 6 To rotate or remove. Unscrew retaining nut, pull anti-siphon vertically and rotate or replace anti-siphon assembly. Tighten up retaining nut and ensure raised lip is retained.