

# showermate

THE  
BATHROOM  
SHOWROOM

## Standard Single Pumps

Standard Single pumps are designed to improve water supplies to single taps or to pump blended water from a shower mixer. Suitable for positive head applications only.

Suitable for domestic use only, Showermate Standard pumps are suitable for installation into open vented hot and cold water systems.

Standard pumps require a flow of just 0.8 l/min through the outlet to start.



### Features

- Durable plastic construction
- 2.6 bar performance
- Automatic switching
- EPDM/PTFE/Al. Oxide seal
- Continuously rated
- 15 mm push-in flexible hoses with integral isolating valves on inlets
- G  $\frac{3}{4}$  threaded connections
- Pre-wired with 1.5 metre power cable
- Anti-vibration feet
- 3-year guarantee (subject to conditions)

### Application

- Boost the water pressure in either the hot or cold supply
- Suitable for single or multiple (up to 4) outlets within a bathroom subject to correct specification and pump sizing

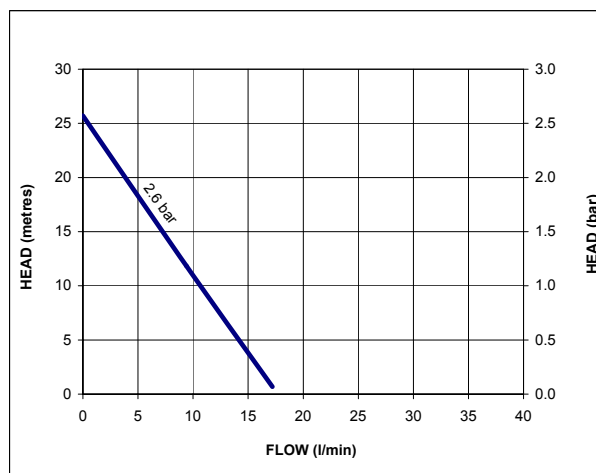

For further advice on selecting the correct pump call  
or e-mail [info@stpumps.co.uk](mailto:info@stpumps.co.uk)

**pumpassist**  
HELPLINE +44 (0) 800 31 969 80

# showermate

Pump Model		S2.6 bar Single 19326
General	Guarantee	3 years
	WRAS approval	1207070
Features	Pump type	Peripheral
	Mechanical seal	EPDM / PTFE / Al. Oxide
	Anti-vibration feet	✓
	Flexible hoses	2
	Dry run protection	✓
Materials	Pump body	Plastic
	Impeller	Plastic
Performance	Maximum head (closed valve)	2.6 bar
	Performance @ 9 l/min	1.3 bar
	Performance @ 18 l/min	0 bar
	Maximum flow	18 l/min
	Maximum static inlet pressure	13 metres
	Maximum working pressure*	380 kPa (3.8 bar)
	Maximum ambient air temperature	40 °C
	Min / Max water temperature**	Min 4 °C / Max 65 °C
Connections	Flow switch sensitivity (approx)	0.8 l/min
	Pump connections	G ¾ male
Flexible hoses	Connections	G ¾ female x 15 mm push-in x 200 mm long, isolating valves on inlet hose
Motor	Type	Induction, auto-reset thermal trip
	Duty rating	Continuous (S1) @ 9 l/min and above
Electrical	Power supply / phase / frequency	230 V a.c. / 1 / 50 Hz
	Current (full load)	1.1 Amps
	Power consumption	245 Watts
	Fuse rating	5 Amps
	Power cable (pre-wired)	1.5 metres
Physical	Enclosure protection	IP22
	Length	223 mm
	Width	132 mm
	Height (excluding hoses)	179 mm
	Weight (including fittings)	3.9 Kg

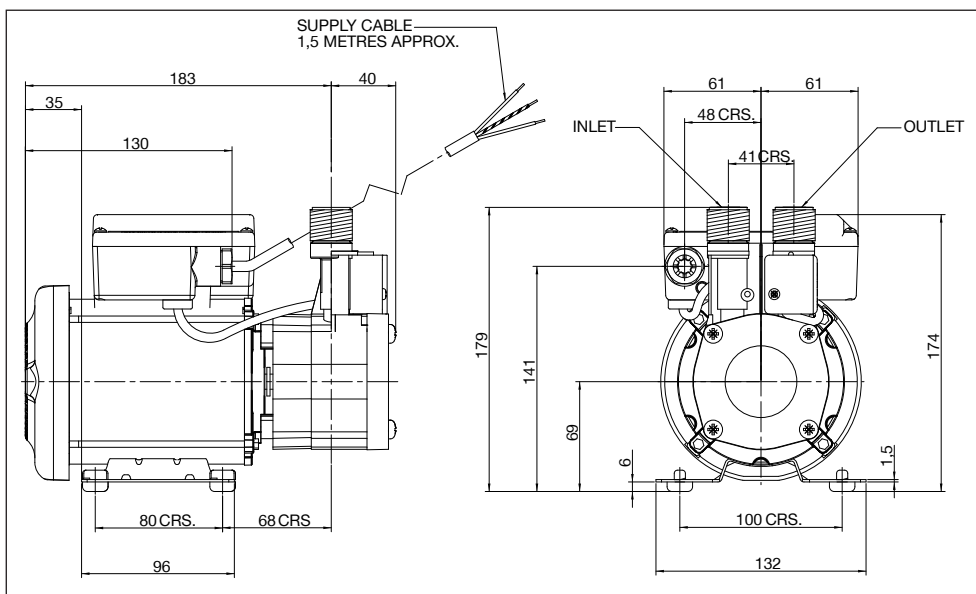

\* The maximum pressure that can be applied to the pump under any installation conditions.

\*\* A stored water temperature of 60 °C is considered sufficient to meet all normal requirements and will minimise deposition of scale in hard water areas.

Stuart Turner Limited reserves the right to amend specifications without notice.